

ALL NOTES AND DATA ARE LISTED ON D-1

REV	REVISION	DATE	ECN	NAME	CHKD
B-1	RELEASE TO PRODUCTION	10/03/13	PXEC0029	AJL	KMD
C-1	CHANGED RUNG 27,LAYOUT,DATA TBL5,ADD TIME DELAY RLY,CHANGE NAME FRM 'S416A' TO 'S416X'	01/15/15	PXEC0093	KMD	DMS
D-1	ADD ISOLATION RELAYS	04/29/15	PXEC0093	AJL	KMD
E-1	UPDATED BACNET CARD	07/20/15	PXEC0110	AJL	KMD
F	ADDED FAN WIRING	09/10/18	PXEC0165	AKH	KMD

OPTIONAL:	SINGLE CYLINDER PUMPS	<input type="checkbox"/>
	DOUBLE-CYLINDER PUMPS	<input type="checkbox"/>
	TRIPLE-CYLINDER PUMPS	<input type="checkbox"/>
BACNET, WEBSVR, SCROLL PUMPS	SCROLL PUMPS	<input checked="" type="checkbox"/>



CONFIDENTIAL DISCLOSURE
 This drawing is the property of the CAMPBELL GROUP of the SCOTT FETZER COMPANY and subject to return on demand. Its contents are confidential and must not be copied or submitted to outside parties for use or examination.

DRAWN BY	CHECKED BY	ENGINEERING APPROVAL
AJL	KMD	DMS
10/03/13	10/03/13	10/03/13

PANEL TYPE
 QUAD MED 2xSCROLL PER PLEX
 HMI, NFPA

DWG. TYPE
 WIRING

DWG. NO.
 PXMI-S416X

SHEET W-1	SIZE B
--------------	-----------

REV	REVISION	DATE	ECN	NAME	CHKD
B-1	RELEASE TO PRODUCTION	10/03/13	PXEC0029	AJL	KMD
C-1	CHANGED RUNG 27 LAYOUT, DATA TBL'S, ADD TIME DELAY RLY, CHANGE NAME FRM 'S416A' TO 'S416X'	01/15/15	PXEC0093	KMD	DMS
D-1	ADD ISOLATION RELAYS	04/29/15	PXEC0093	AJL	KMD
E-1	UPDATED BACNET CARD	07/20/15	PXEC0110	AJL	KMD
F	ADDED FAN WIRING	09/10/18	PXEC0169	AKH	KMD

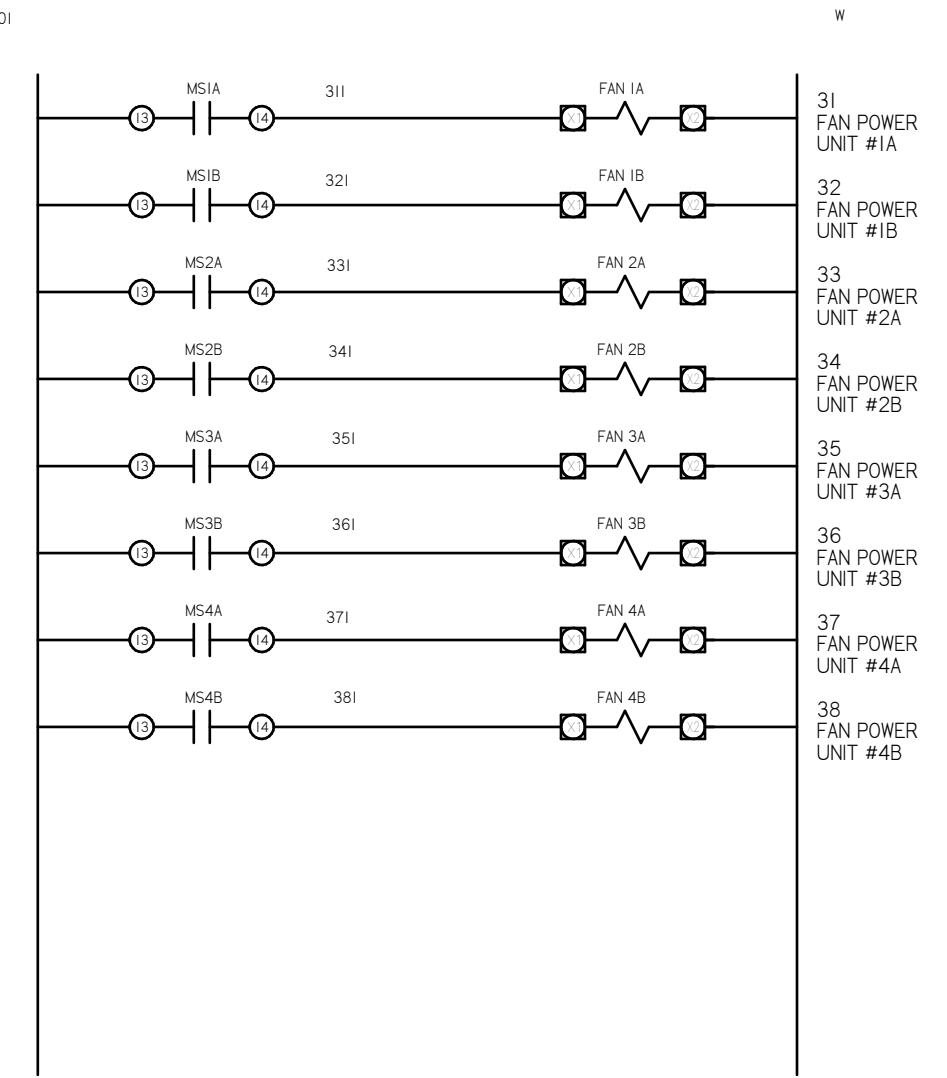
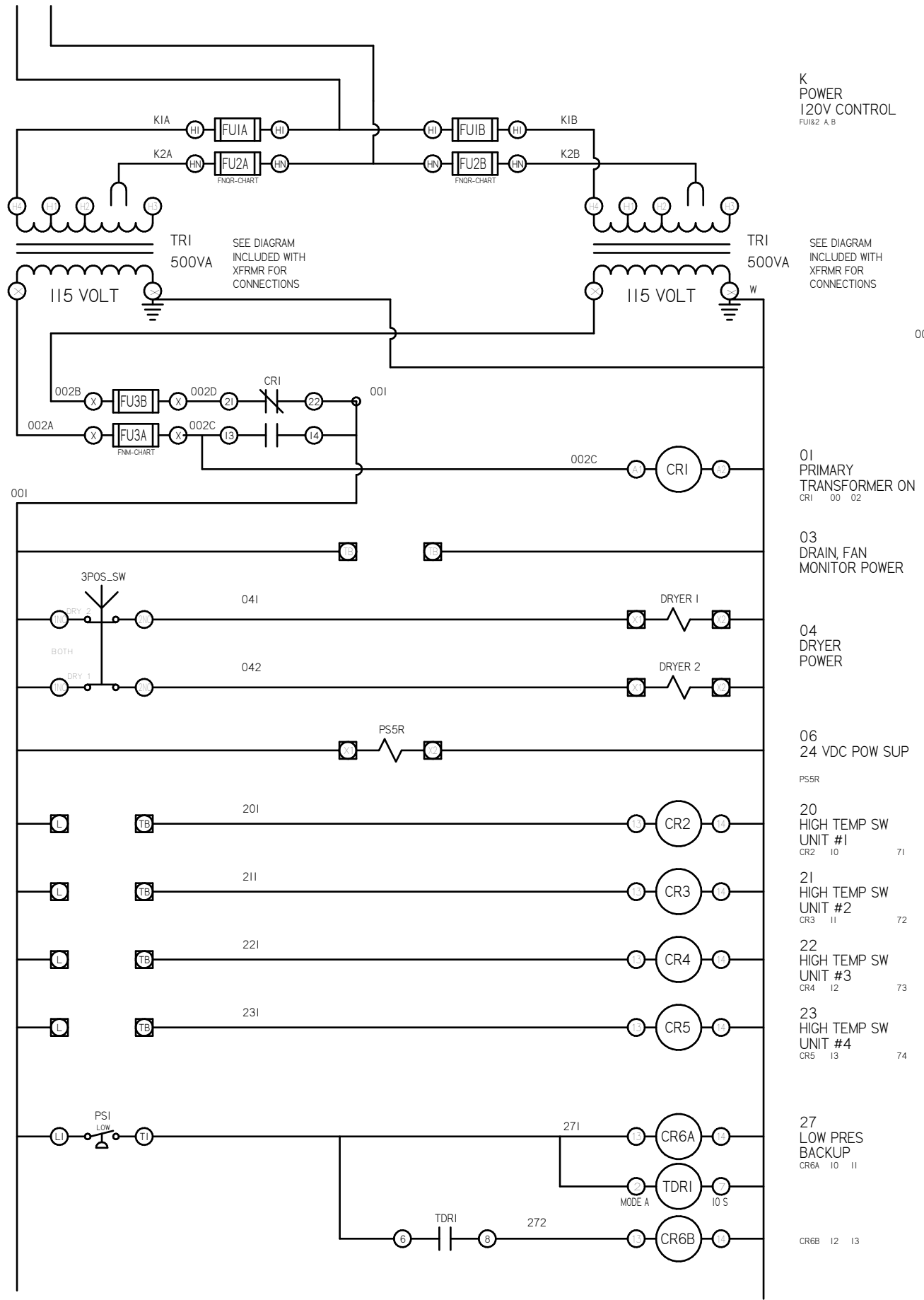

OPTIONAL:

SINGLE CYLINDER PUMPS	<input type="checkbox"/>
DOUBLE-CYLINDER PUMPS	<input type="checkbox"/>
TRIPLE-CYLINDER PUMPS	<input type="checkbox"/>
BACNET, WEBSVR, SCROLL PUMPS	<input checked="" type="checkbox"/>



CONFIDENTIAL DISCLOSURE:
This drawing is the property of the CAMPBELL GROUP of the SCOTT FETZER COMPANY and subject to return on demand. Its contents are confidential and must not be copied or submitted to outside parties for use or examination.

DRAWN BY	CHECKED BY	ENGINEERING APPROVAL
AJL	KMD	DMS
10/03/13	10/03/13	10/03/13

PANEL TYPE
QUAD MED 2xSCROLL PER PLEX
HMI, NFPA

DWG. TYPE WIRING

DWG. NO. PXMI-S416X

SHEET W-2 SIZE B

REV	REVISION	DATE	ECN	NAME	CHKD
B-1	RELEASE TO PRODUCTION	10/03/13	PXEC0029	AJL	KMD
C-1	CHANGED RUNG 27_LAYOUT DATA TBL5 ADD TIME DELAY RLY, CHANGE NAME FRM 'S416A' TO 'S416X'	01/15/15	PXEC0093	KMD	DMS
D-1	ADD ISOLATION RELAYS	04/29/15	PXEC0093	AJL	KMD
E-1	UPDATED BACNET CARD	07/20/15	PXEC0110	AJL	KMD
F	ADDED FAN WIRING	09/10/18	PXEC0169	AKH	KMD

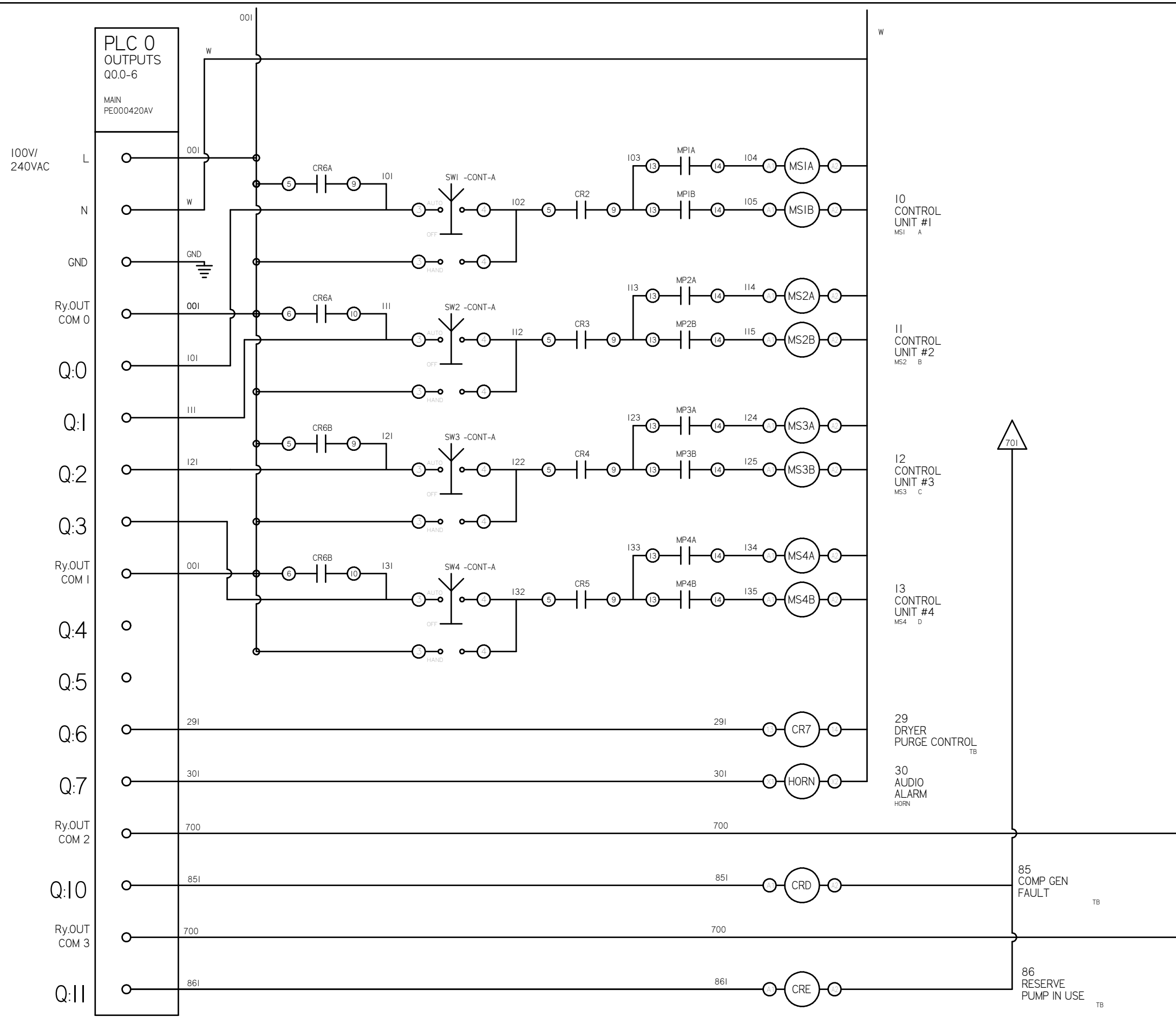

OPTIONAL:

SINGLE CYLINDER PUMPS	<input type="checkbox"/>
DOUBLE-CYLINDER PUMPS	<input type="checkbox"/>
TRIPLE-CYLINDER PUMPS	<input type="checkbox"/>
SCROLL PUMPS	<input checked="" type="checkbox"/>

BACNET, WEBSVR,



CONFIDENTIAL DISCLOSURE:
This drawing is the property of the CAMPBELL GROUP of the SCOTT FETZER COMPANY and subject to return on demand. Its contents are confidential and must not be copied or submitted to outside parties for use or examination.

DRAWN BY	CHECKED BY	ENGINEERING APPROVAL
AJL	KMD	DMS
10/03/13	10/03/13	10/03/13

PANEL TYPE
QUAD MED 2xSCROLL PER PLEX HMI, NFPA

DWG. TYPE
WIRING

DWG. NO.
PXMI-S416X

SHEET
W-3

SIZE
B

REV	REVISION	DATE	ECN	NAME	CHKD
B-1	RELEASE TO PRODUCTION	10/03/13	PXEC0029	AJL	KMD
C-1	CHANGED RUNG 27,LAYOUT,DATA TBL,ADD TIME DELAY RLY,CHANGE NAME FRM 'S416A' TO 'S416X'	01/15/15	PXEC0093	KMD	DMS
D-1	ADD ISOLATION RELAYS	04/29/15	PXEC0093	AJL	KMD
E-1	UPDATED BACNET CARD	07/20/15	PXEC0110	AJL	KMD
F	ADDED FAN WIRING	09/10/18	PXEC0169	AKH	KMD

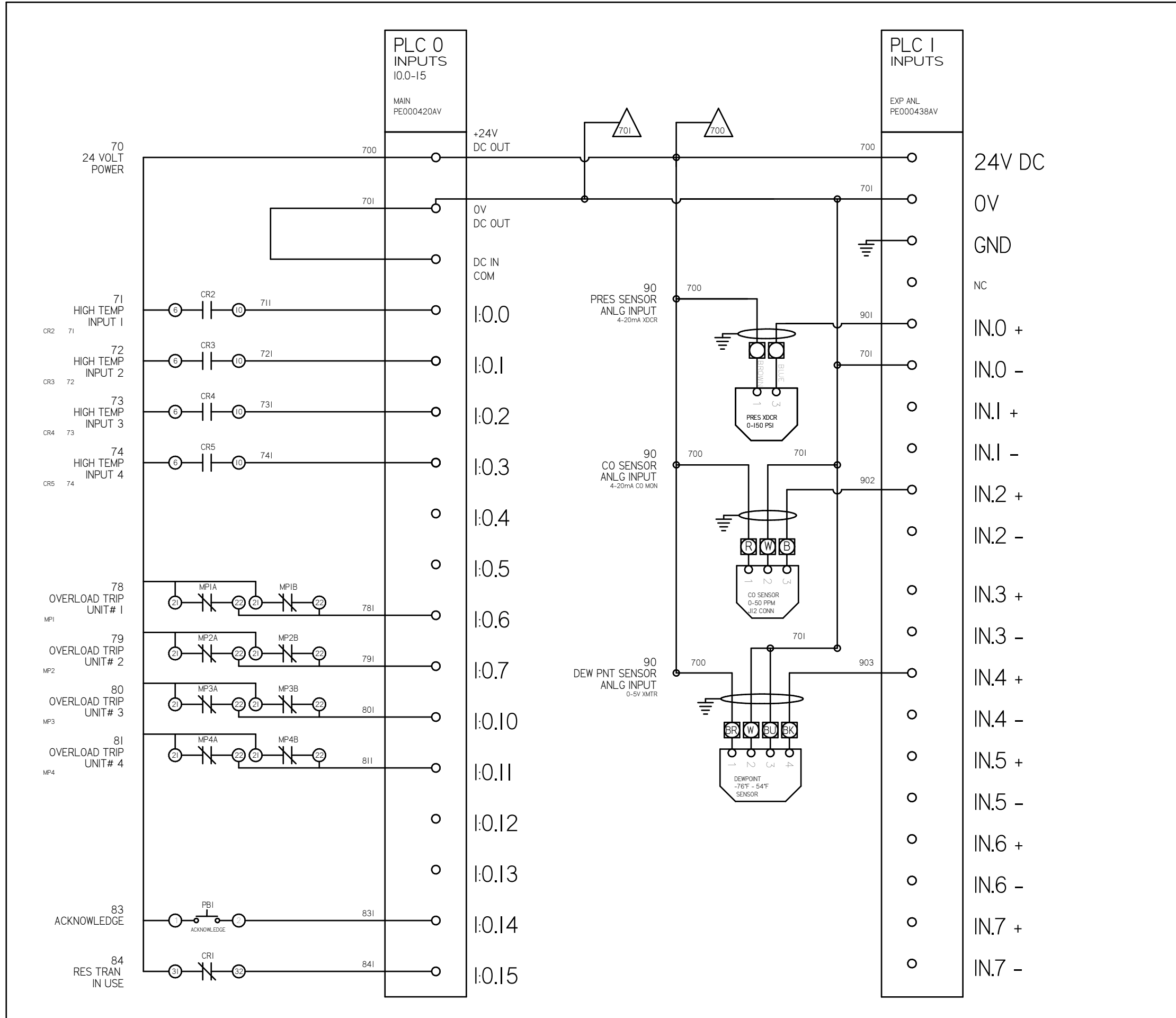

OPTIONAL:

SINGLE CYLINDER PUMPS	<input type="checkbox"/>
DOUBLE-CYLINDER PUMPS	<input type="checkbox"/>
TRIPLE-CYLINDER PUMPS	<input type="checkbox"/>
SCROLL PUMPS	<input checked="" type="checkbox"/>

BACNET, WEBSVR,



CONFIDENTIAL DISCLOSURE:
This drawing is the property of the CAMPBELL GROUP of the SCOTT FETZER COMPANY and subject to return on demand. Its contents are confidential and must not be copied or submitted to outside parties for use or examination.

DRAWN BY	CHECKED BY	ENGINEERING APPROVAL
AJL	KMD	DMS
10/03/13	10/03/13	10/03/13

PANEL TYPE
QUAD MED 2xSCROLL PER PLEX
HMI, NFPA

DWG. TYPE
WIRING

DWG. NO.
PXMI-S416X

SHEET	SIZE
W-4	B

REV	REVISION	DATE	ECN	NAME	CHKD
B-1	RELEASE TO PRODUCTION	10/03/13	PXEC0029	AJL	KMD
C-1	CHANGED RUNG 27,LAYOUT,DATA TBL,ADD TIME DELAY RLY,CHANGE NAME FRM 'S416A' TO 'S416X'	01/15/15	PXEC0093	KMD	DMS
D-1	ADD ISOLATION RELAYS	04/29/15	PXEC0093	AJL	KMD
E-1	UPDATED BACNET CARD	07/20/15	PXEC0110	AJL	KMD
F	ADDED FAN WIRING	09/10/18	PXEC0169	AKH	KMD

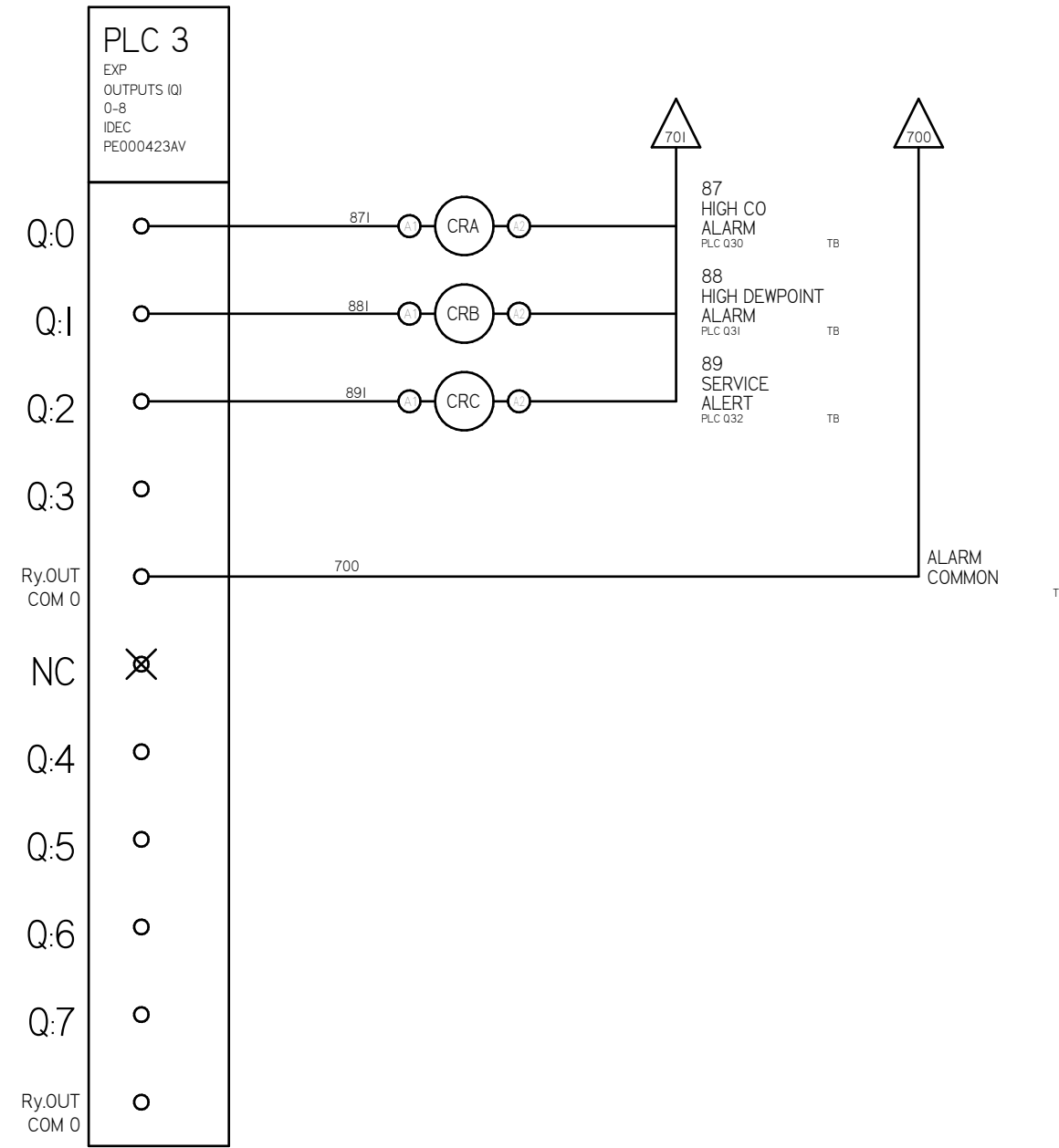
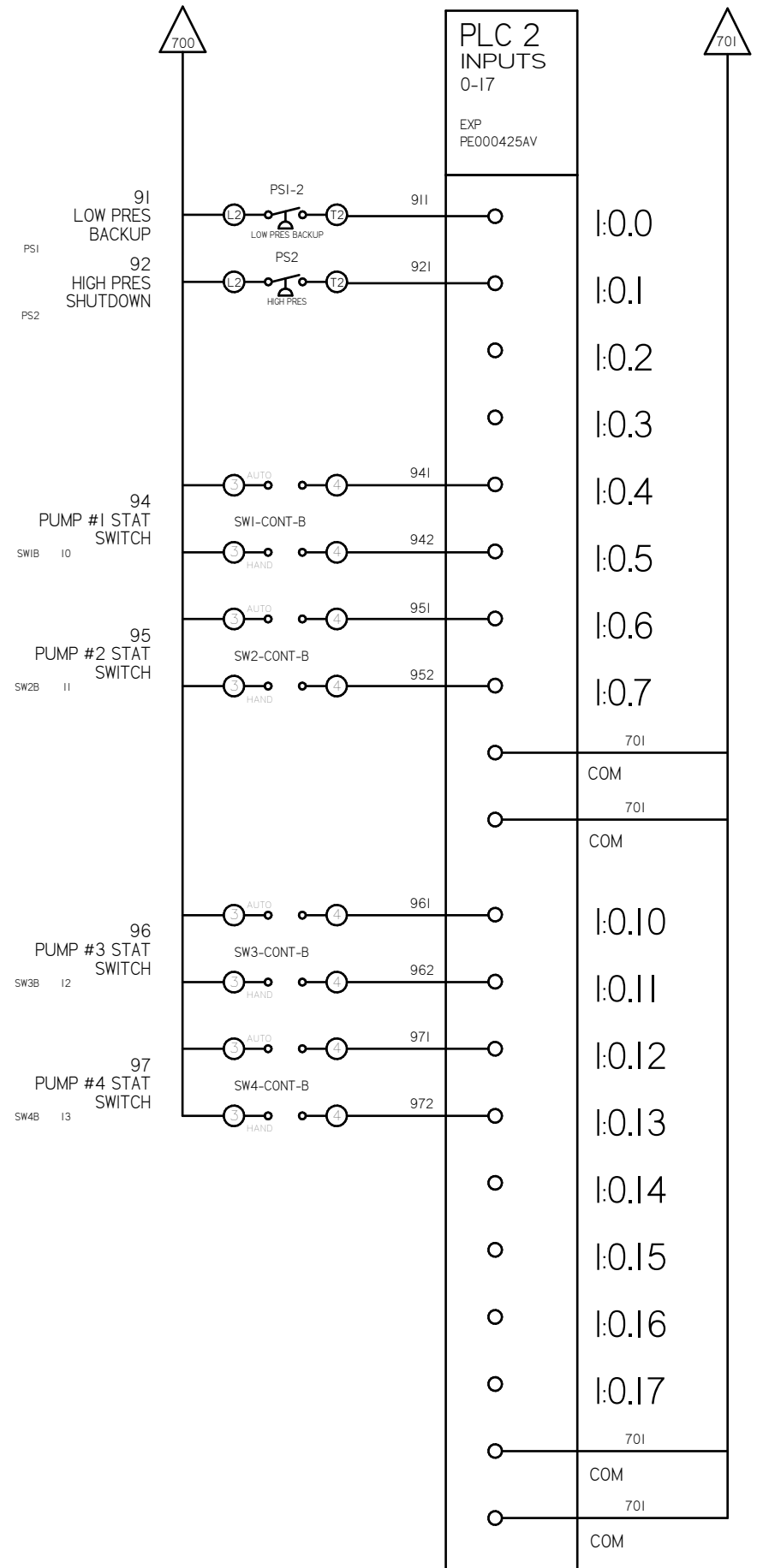

OPTIONAL:	SINGLE CYLINDER PUMPS	<input type="checkbox"/>
	DOUBLE-CYLINDER PUMPS	<input type="checkbox"/>
	TRIPLE-CYLINDER PUMPS	<input type="checkbox"/>
BACNET, WEBSRV, R	SCROLL PUMPS	<input checked="" type="checkbox"/>



CONFIDENTIAL DISCLOSURE:
This drawing is the property of the CAMPBELL GROUP of the SCOTT FETZER COMPANY and subject to return on demand. Its contents are confidential and must not be copied or submitted to outside parties for use or examination.

DRAWN BY	CHECKED BY	ENGINEERING APPROVAL
AJL	KMD	DMS
10/03/13	10/03/13	10/03/13

PANEL TYPE
QUAD MED 2xSCROLL PER PLEX
HMI, NFPA

DWG. TYPE WIRING

DWG. NO. PXMI-S416X

SHEET	SIZE
W-5	B

REV	REVISION	DATE	ECN	NAME	CHKD
B-1	RELEASE TO PRODUCTION	10/03/13	PXEC0029	AJL	KMD
C-1	CHANGED RUNG 27,LAYOUT,DATA TBL,ADD TIME DELAY RLY,CHANGE NAME FRM 'S416A' TO 'S416X'	01/15/15	PXEC0093	KMD	DMS
D-1	ADD ISOLATION RELAYS	04/29/15	PXEC0093	AJL	KMD
E-1	UPDATED BACNET CARD	07/20/15	PXEC0110	AJL	KMD
F	ADDED FAN WIRING	09/10/18	PXEC0165	AKH	KMD

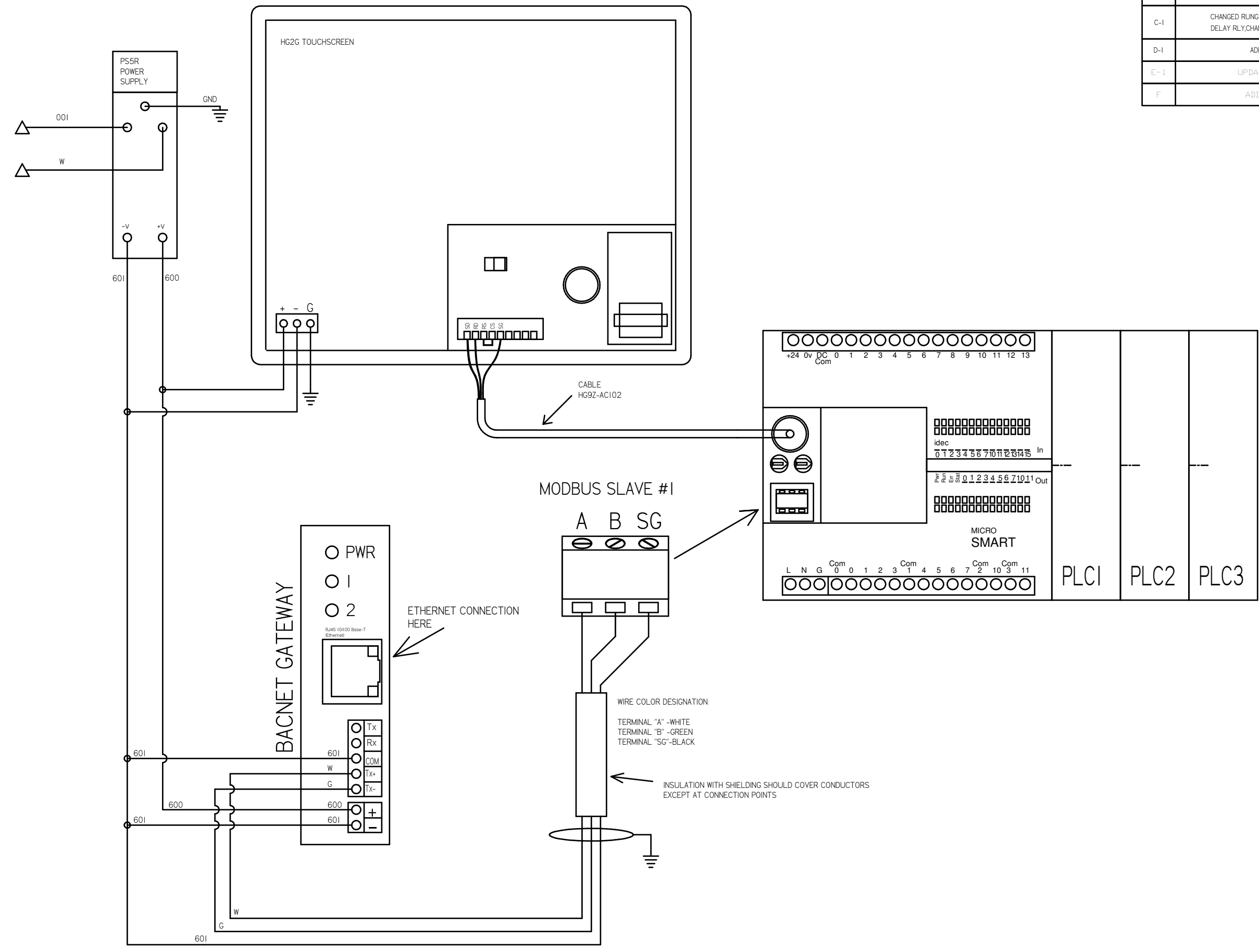

OPTIONAL:	SINGLE CYLINDER PUMPS	<input type="checkbox"/>
	DOUBLE-CYLINDER PUMPS	<input type="checkbox"/>
BACNET, WEBSVR,	TRIPLE-CYLINDER PUMPS	<input type="checkbox"/>
	SCROLL PUMPS	<input checked="" type="checkbox"/>



CONFIDENTIAL DISCLOSURE:
This drawing is the property of the CAMPBELL GROUP of the SCOTT FETZER COMPANY and subject to return on demand. Its contents are confidential and must not be copied or submitted to outside parties for use or examination.

DRAWN BY	CHECKED BY	ENGINEERING APPROVAL
AJL	KMD	DMS
10/03/13	10/03/13	10/03/13

PANEL TYPE
QUAD MED 2xSCROLL PER PLEX
HMI, NFPA

DWG. TYPE
WIRING

DWG. NO.
PXMI-S416X

SHEET	SIZE
W-6	B

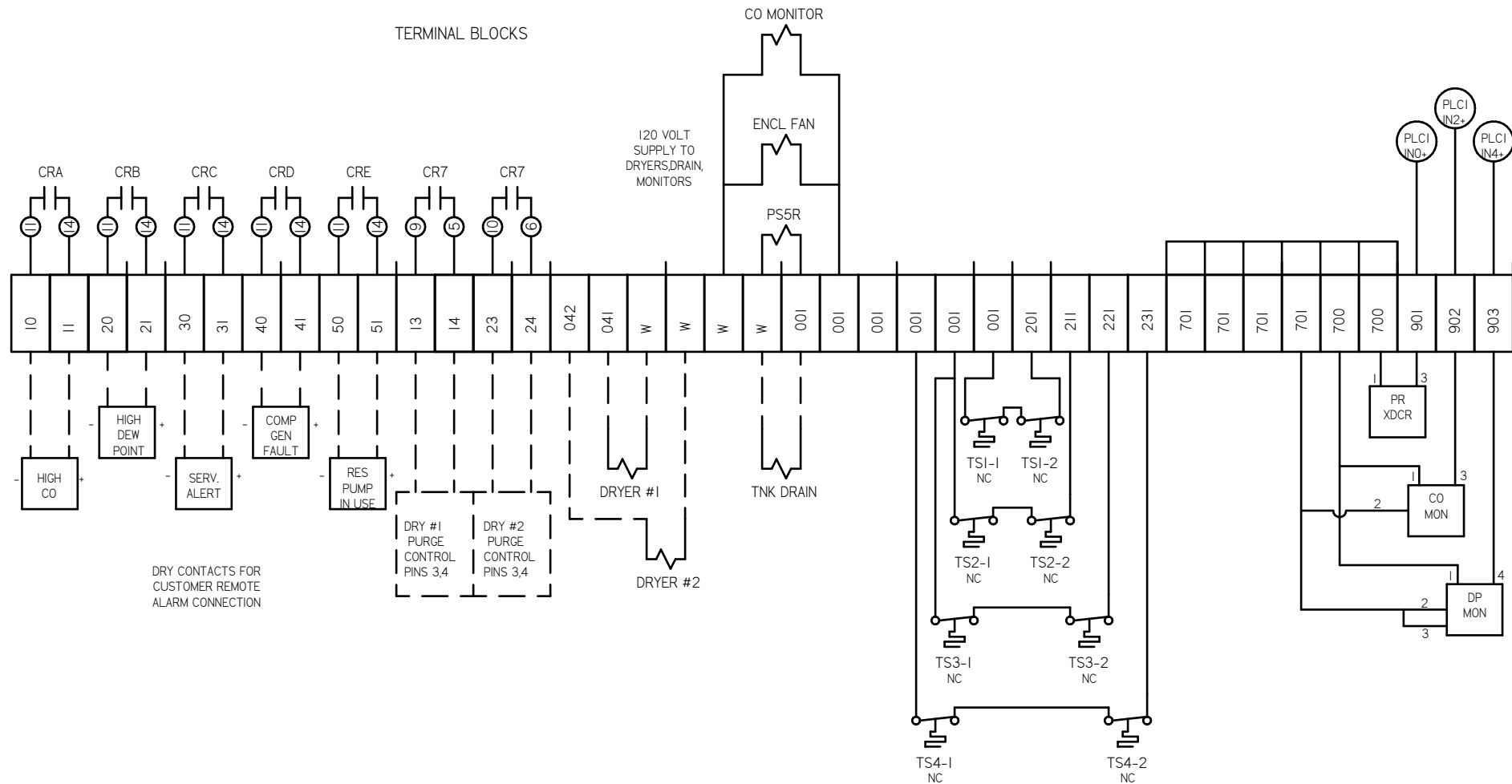

REV	REVISION	DATE	ECN	NAME	CHKD
B-1	RELEASE TO PRODUCTION	10/03/13	PXEC0029	AJL	KMD
C-1	CHANGED RUNG 27_LAYOUT_DATA TBL_SADD TIME DELAY RLY, CHANGE NAME FRM 'S416A' TO 'S416X'	01/15/15	PXEC0093	KMD	DMS
D-1	ADD ISOLATION RELAYS	04/29/15	PXEC0093	AJL	KMD
E-1	UPDATED BACNET CARD	07/20/15	PXEC0118	AJL	KMD
F	ADDED FAN WIRING	09/10/18	PXEC0169	AKH	KMD

ASSEMBLY NOTE:

USE SHIELDED CABLE BETWEEN TERMINAL BLOCKS AND PLC. CONNECT GROUND LOOPS TO GROUND BLOCK. CABLE IS NOT TO BE ROUTED WITHIN A PROXIMITY OF 2" OF ANY 3-PHASE POWER CONDUCTORS.

OPTIONAL:	SINGLE CYLINDER PUMPS	<input type="checkbox"/>
	DOUBLE-CYLINDER PUMPS	<input type="checkbox"/>
	TRIPLE-CYLINDER PUMPS	<input type="checkbox"/>
BACNET, WEBSVR,	SCROLL PUMPS	<input checked="" type="checkbox"/>



CONFIDENTIAL DISCLOSURE:
This drawing is the property of the CAMPBELL GROUP of the SCOTT FETZER COMPANY and subject to return on demand. Its contents are confidential and must not be copied or submitted to outside parties for use or examination.

DRAWN BY	CHECKED BY	ENGINEERING APPROVAL
AJL	KMD	DMS
10/03/13	10/03/13	10/03/13

PANEL TYPE
QUAD MED 2xSCROLL PER PLEX
HMI, NFPA

DWG. TYPE
WIRING

DWG. NO.
PXMI-S416X

SHEET W-7	SIZE B
--------------	-----------

FIELD WIRING NOTES:

- PANEL GROUND MUST BE CONNECTED TO EARTH GROUND.
- TRANSFORMER IS SIZED FOR LOADS SHOWN ON DRAWING ONLY.
- FIELD WIRING INDICATED BY -----. WIRE TO BE COPPER RATED AT 75° C.
- ALL ALARM DRY CONTACTS ARE CLOSED FOR NORMAL OPERATION AND OPEN IN ALARM.
- DRY CONTACT RATING: 30V DC/2A (resistive load, inductive load L/R = 7 ms)
- USE CAT-5 CABLE W/RJ45 CONNECTOR FOR ETHERNET CONNECTION TO COMMUNICATION NETWORK OR BAS SYSTEM



FAN WIRING
SEE RUNGS 31-38 FOR DETAILS

TABLE 1

PANEL DATA 3Ø - 60 Hz 500VA CONTROL CIRCUIT					(B) BRANCH CIRCUIT PROTECTION - PROVIDED BY INSTALLER		
(A) LOAD SPECIFICATIONS					NON-TIME DELAY FUSE	TIME-DELAY FUSE	INVERSE-TIME CIRCUIT BREAKER
PANEL PART NUMBER	MOTOR SIZE EACH	(A) POWER (V/PH)	(A) MOTOR LOAD EACH (FLA)	PANEL LOAD TOTAL (FLA)			
PXMIS416A2AJ	5(X2)	208V/3Ø	14.0	114	150A	125A	150A
PXMIS416A3AJ	5(X2)	230V/3Ø	12.7	104	150A	125A	125A
PXMIS416A4AJ	5(X2)	460V/3Ø	6.33	53	70A	60A	70A
PXMIS416E2AJ	7.5(X2)	208V/3Ø	19.2	156	200A	175A	200A
PXMIS416E3AJ	7.5(X2)	230V/3Ø	17.3	141	200A	175A	200A
PXMIS416E4AJ	7.5(X2)	460V/3Ø	8.67	72	90A	80A	90A
PXMIS416G2AJ	10(X2)	208V/3Ø	26.5	214	300A	250A	300A
PXMIS416G3AJ	10(X2)	230V/3Ø	24.0	194	250A	225A	250A
PXMIS416G4AJ	10(X2)	460V/3Ø	12.0	98	125A	110A	125A

NOTE - ADJUST OVERCURRENT PROTECTION DEVICE NOT TO EXCEED
115% OF MOTOR NAMEPLATE FLA VALUE

NOTES:

- RECOMMENDED TIGHTENING TORQUES FOR WIRE TERMINALS:
208-575 VOLT POWER 35 POUND INCHES
120 VOLT POWER AND CONTROL 15 POUND INCHES
VOLTAGE
- PANEL GROUND MUST BE CONNECTED TO EARTH GROUND
- INSTALLER TO PROVIDE MAIN DISCONNECTING DEVICE WITH
SHORT CIRCUIT PROTECTION FOR THIS ELECTRICAL ASSEMBLY.
SEE TABLE 1 FOR REQUIREMENTS.
- ALL WIRES MUST BE LABELED ON BOTH ENDS
- TRANSFORMER IS SIZED FOR LOADS SHOWN ON DRAWING ONLY.
DO NOT CONNECT ANY OTHER DEVICES
- △ -INDICATES A DRAWING WIRE CONNECTION TO ANOTHER PAGE.

FIELD WIRING NOTES ON PAGE W-7.

REV	REVISION	DATE	ECN	NAME	CHKD
B-1	RELEASE TO PRODUCTION	10/03/13	PXEC0029	AJL	KMD
C-1	CHANGED RUNG 27 LAYOUT DATA TBL SADD TIME DELAY RLY CHANGE NAME FRM 'S416A' TO 'S416X'	01/15/15	PXEC0093	KMD	DMS
D-1	ADD ISOLATION RELAYS	04/29/15	PXEC0093	AJL	KMD
E-1	UPDATED BACNET CARD	07/20/15	PXEC0110	AJL	KMD
F	ADDED FAN WIRING	09/10/18	PXEC0165	AKH	KMD

WIRE TYPE TABLE			
VOLTAGE	WIRE NUMBERS	GAUGE	COLOR
120 VAC	01-699	16-18 AWG	RED/BLK
0VAC	W	16-18 AWG	WHT/BLK
24VDC	700-799	16-18 AWG	PURPLE
0VDC	701	16-18 AWG	PURPLE
GND	-	VARIES	GREEN
CUSTOMER SUPPLY	01-99	16 AWG	YELLOW

TABLE 2 - CONTROL CIRCUIT PROTECTION					
FUSE TYPE		208 VOLT	230 VOLT	460 VOLT	575 VOLT
FU1,2A FU1,2B	FNQR	6A	5A	5A	4A
FU3AB	FNM	7A	7A	7A	7A

OPTIONAL:	SINGLE CYLINDER PUMPS	<input type="checkbox"/>
	DOUBLE-CYLINDER PUMPS	<input type="checkbox"/>
	TRIPLE-CYLINDER PUMPS	<input type="checkbox"/>
BACNET, WEBSVR,	SCROLL PUMPS	<input checked="" type="checkbox"/>



CONFIDENTIAL DISCLOSURE:
This drawing is the property of the CAMPBELL GROUP of the SCOTT FETZER
COMPANY and subject to return on demand. Its contents are confidential
and must not be copied or submitted to outside parties for use or
examination.

DRAWN BY	CHECKED BY	ENGINEERING APPROVAL
AJL	KMD	DMS
10/03/13	10/03/13	10/03/13

PANEL TYPE
QUAD MED 2xSCROLL PER PLEX
HMI, NFPA

DWG. TYPE DATA

DWG. NO.
PXMI-S416X

SHEET D-1	SIZE B
--------------	-----------

SEQUENCE OF OPERATIONS

During normal operation the PBMI controller will signal the Lead compressor to run when pressure drops below lead cut-in set-point and stop when the pressure reaches the lead cut-out set-point. Lead alternation to the next pump, will occur with each lead run signal or every 10-minutes (which ever happens first). If demand cannot be satisfied by the lead pump, the lag pump(s) will start and stop based upon the lag cut-in and cut-out set-points. When more than one pump is running, lead alternation will occur when the lowest cut-out set-point is satisfied, or after 10-minutes (which ever happens first). The HOA switch's place the pump in the following modes: Hand-turns pump on to run continuous. Off-disables pump from running. Auto-places pump in the "ready mode" and will start and stop based on sequence described above.

All plex configurations include a hardwired Back-up pressure switch circuit should a control failure occur. This circuit will call all pumps on and off based on the reserve pressure switch set-points.

Expandable systems include all control devices, operators, and programming for the maximum number of pumps (or plex) required. To expand the system: navigate to the "service screen" and enter the number of pumps.

Additional information and descriptions can be accessed through the HMI "service info" screen by pressing Sequence of Operations button.

REV	REVISION	DATE	ECN	NAME	CHKD
B-1	RELEASE TO PRODUCTION	10/03/13	PXEC0029	AJL	KMD
C-1	CHANGED RUNG 27,LAYOUT DATA TBL,ADD TIME DELAY RLY,CHANGE NAME FRM 'S416A' TO 'S416X'	01/15/15	PXEC0093	KMD	DMS
D-1	ADD ISOLATION RELAYS	04/29/15	PXEC0093	AJL	KMD
E-1	UPDATED BACNET CARD	07/20/15	PXEC0110	AJL	KMD
F	ADDED FAN WIRING	09/10/18	PXEC0169	AKH	KMD

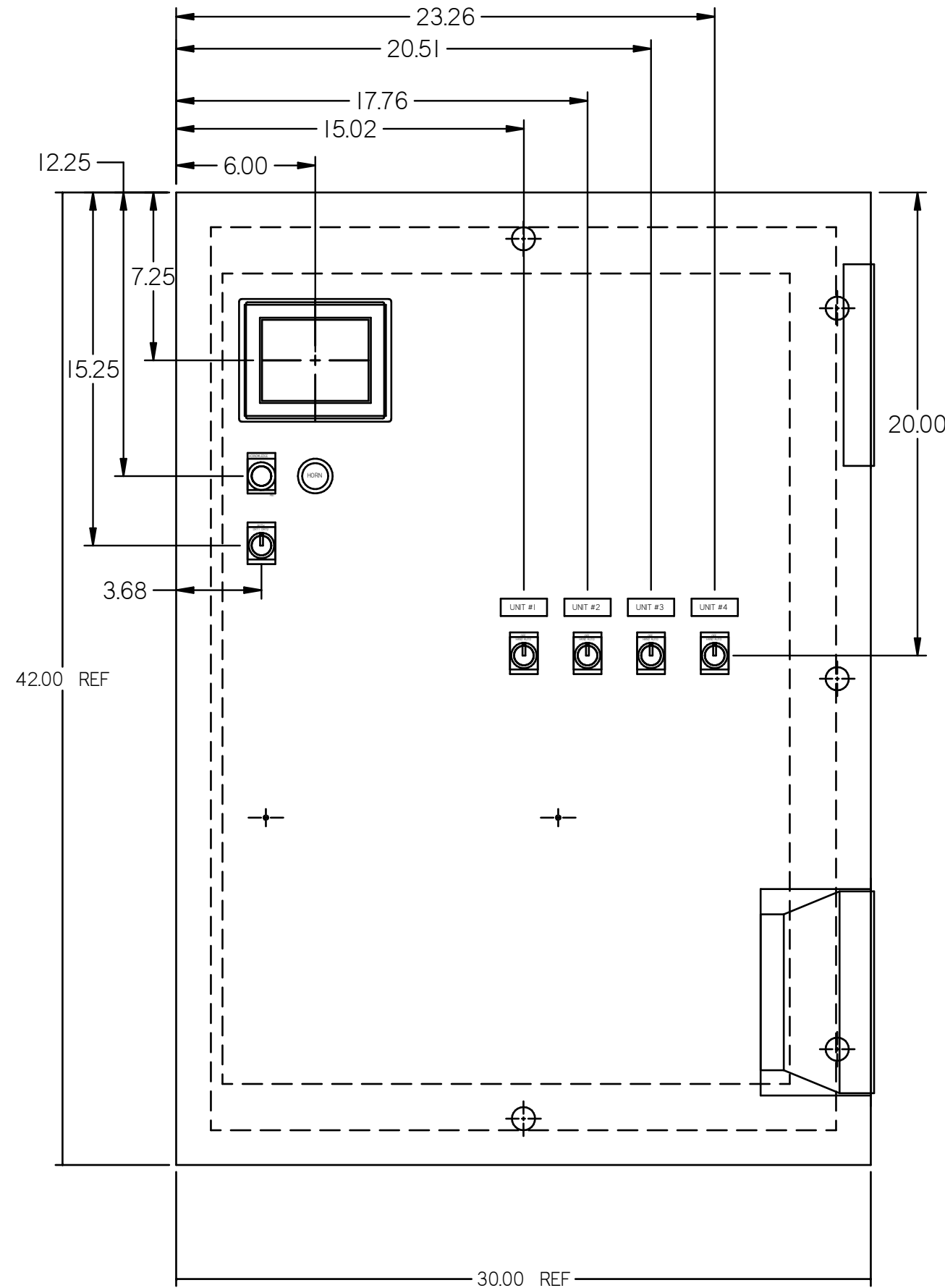

RIGHT SIDE OF ENCLOSURE

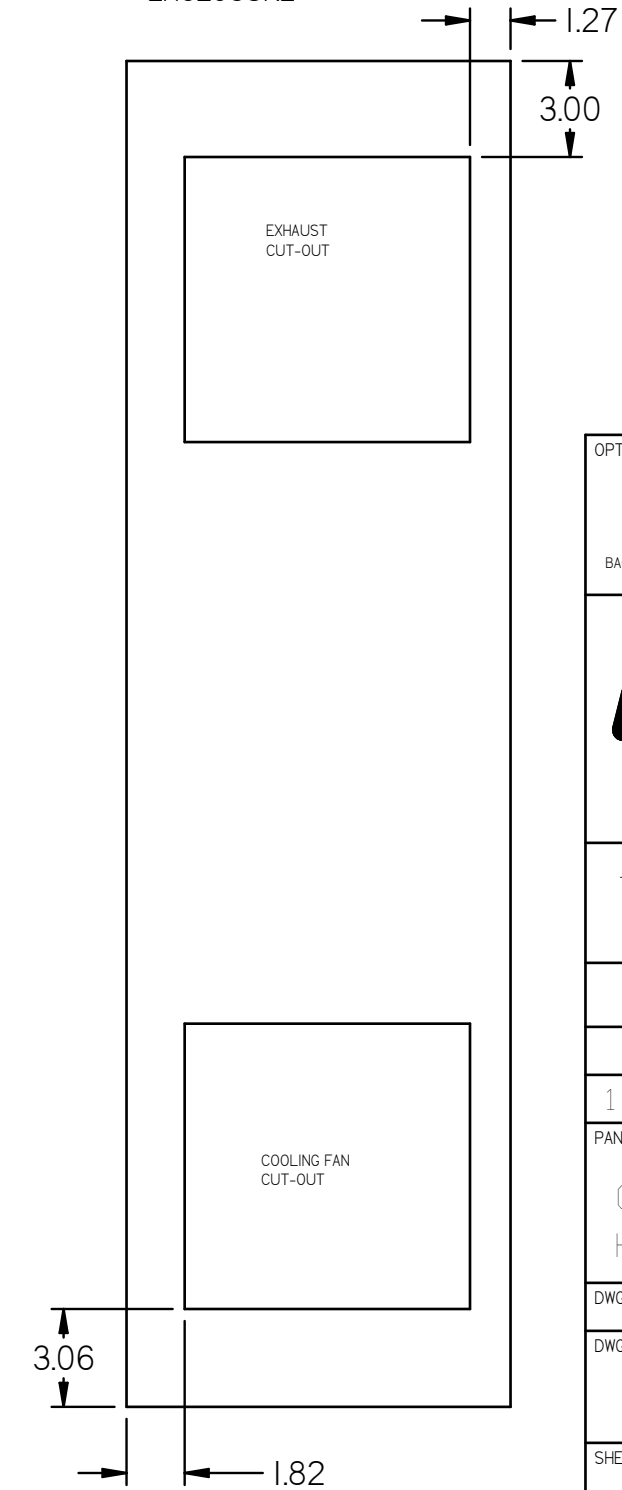

- OPTIONAL:
- SINGLE CYLINDER PUMPS
 - DOUBLE-CYLINDER PUMPS
 - TRIPLE-CYLINDER PUMPS
 - SCROLL PUMPS
- BACNET, WEBSVR,



CONFIDENTIAL DISCLOSURE
 This drawing is the property of the CAMPBELL GROUP of the SCOTT FETZER COMPANY and subject to return on demand. Its contents are confidential and must not be copied or submitted to outside parties for use or examination.

DRAWN BY	CHECKED BY	ENGINEERING APPROVAL
AJL	KMD	DMS
10/03/13	10/03/13	10/03/13

PANEL TYPE
 QUAD MED 10HP SCROLL
 HMI, NFPA

DWG. TYPE LAYOUT

DWG. NO.
 PXMI-S416X

SHEET	SIZE
L-1	B

REV	REVISION	DATE	ECN	NAME	CHKD
B-1	RELEASE TO PRODUCTION	10/03/13	PXEC0029	AJL	KMD
C-1	CHANGED RUNG 27,LAYOUT,DATA TBL,SADD TIME DELAY RLY,CHANGE NAME FRM 'S416A' TO 'S416X'	01/15/15	PXEC0093	KMD	DMS
D-1	ADD ISOLATION RELAYS	04/29/15	PXEC0093	AJL	KMD
E-1	UPDATED BACNET CARD	07/20/15	PXEC0110	AJL	KMD
F	ADDED FAN WIRING	09/10/18	PXEC0165	AKH	KMD

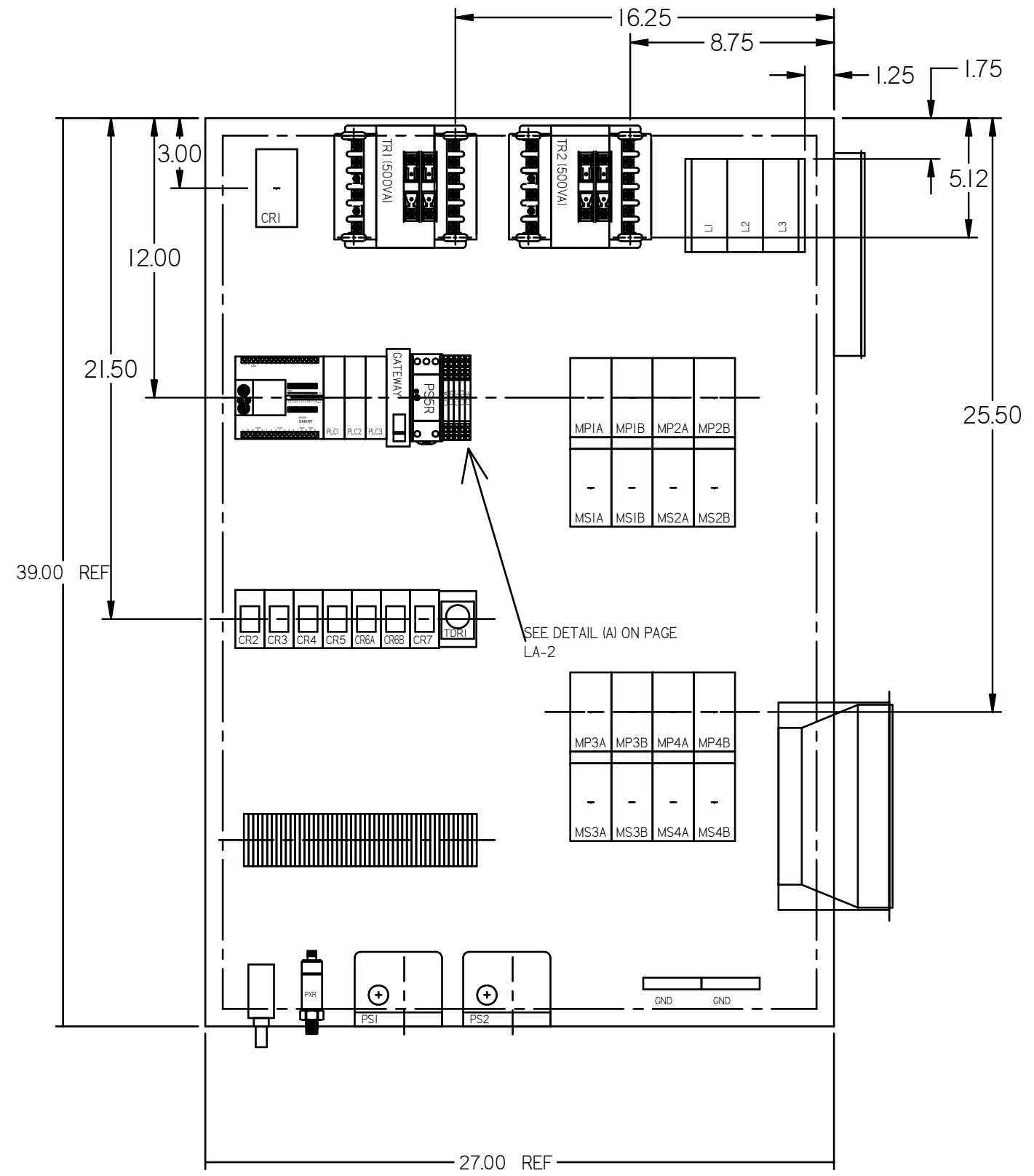

DETAIL (A)

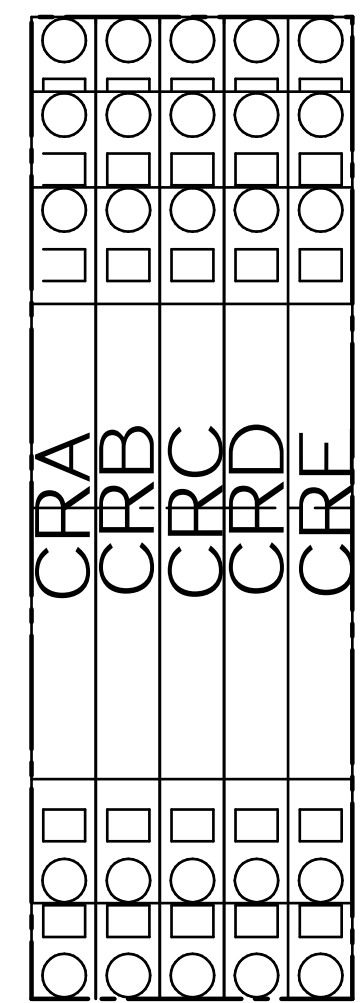

OPTIONAL:

SINGLE CYLINDER PUMPS	<input type="checkbox"/>
DOUBLE-CYLINDER PUMPS	<input type="checkbox"/>
TRIPLE-CYLINDER PUMPS	<input type="checkbox"/>
SCROLL PUMPS	<input checked="" type="checkbox"/>

BACNET, WEBSVR,



CONFIDENTIAL DISCLOSURE:
This drawing is the property of the CAMPBELL GROUP of the SCOTT FETZER COMPANY and subject to return on demand. Its contents are confidential and must not be copied or submitted to outside parties for use or examination.

DRAWN BY	CHECKED BY	ENGINEERING APPROVAL
AJL	KMD	DMS
10/03/13	10/03/13	10/03/13

PANEL TYPE
QUAD MED 2xSCROLL PER PLEX
HMI, NFPA

DWG. TYPE LAYOUT

DWG. NO. PXMI-S416X

SHEET	SIZE
L-2	B